

---

# ASSEMBLY AND INSTALLATION INSTRUCTIONS FOR YOUR GIANT-VAC **SELF-DUMPING GRASS CATCHER** MODEL 1103-AL

---

***Congratulations!*** You have just purchased one of the finest outdoor power equipment accessories on the market today. The Giant-Vac Self-Dumping Grass Catcher is easy to attach to your Giant-Mow, and even easier to operate. Fill it, park it, then pull the dump cord. And if properly cared for, your Self-Dumping Grass Catcher will provide years of trouble-free service.

Each Giant-Vac product leaves our factory in excellent condition; occasionally, however, damage may occur during shipment. If any damage is found upon initial product inspection, save the packing box and immediately notify the transport carrier, as they are solely responsible for any adjustments resulting from such damage.

---

## **ASSEMBLY**

**(Refer to Parts List for correct part identification, as well as correct placement of parts)**

1. Remove mower discharge deflector. (Helpful hint: After removing deflector from mower, replace hardware onto mounting brackets on deflector and store in a convenient place for future use.) **Do not discard deflector. It is an important safety feature. See warning below.**
2. Attach Catcher Receiving Bracket (Parts List Ref. # 7) to attaching bracket on mower (See Parts List for correct placement) using four 3/8 x 3/4" bolts, lockwashers and flatwashers (# 8)
3. Install Reinforcement Brace (# 9) between Catcher Receiving Bracket and attaching bracket on mower (See Parts List for correct placement) using two 3/8 x 1" bolts, flatwashers, lockwashers and nuts (# 10).
4. Thread one 5/16 nut (# 6c) onto each end of both Catcher Carrying Handles (# 6), followed by one 5/16 flatwasher (# 6a). Next, drop handles into corresponding holes in top ends of Catcher Body (# 1), securing with second flatwasher (#6a), lockwasher (# 6b) and nut (#6c). Tighten securely.
5. With open side facing mower, lift Catcher Body by handles, tilting top of body toward mower, and insert pin on Front Pivot Pin Bracket (#2) into front hanger hole on Catcher Receiving Bracket. Next, slide pin on Rear Pivot Pin Bracket (#3) into rear hanger slot on receiving bracket, making sure pin drops fully into rear locking portion of slot. Now lower bottom of catcher body into resting position against bottom of receiving bracket. Note: Catcher should butt tightly against receiving bracket, with little or no space between catcher and bracket, especially along bottom edge. If this is not the case, loosen pivot brackets on body and adjust accordingly.

***Assembly and installation of your Giant-Vac Grass Catcher is now complete.  
Please refer to your Giant-Mow operator's manual for safe and effective mowing.***

---

## **! DANGER !**

**ATTEMPTING TO OPERATE MOWER WITHOUT CATCHER BODY IN PLACE CAN RESULT IN SERIOUS INJURY. IN SITUATIONS WHERE CATCHER USE IS NOT CONVENIENT OR PREFERRED, REMOVE ENTIRE ASSEMBLY AND RE-ATTACH MOWER DISCHARGE DEFLECTOR.**

---

---

# **GIANT-VAC WARRANTY**

---

**GIANT-VAC, INC.**, here-in-after called Giant-Vac, warrants each new Giant-Vac to the original retail purchaser of the new Giant-Vac equipment to be free from manufacturing defects in normal service for a period of 1 year, unless it is used for rental purposes, which limits the warranty to 30 days. This warranty does not apply to engines, tires or other parts that are purchased and warranted by their manufacturer. Items such as bags, grass catchers, hoses and blades are not warranted, as these are considered expendable items. This warranty does not include equipment failures due to normal wear.

Any obligation under this warranty is expressly limited to the replacement or repair, at an authorized servicing Giant-Vac dealer, or at a point designated by us, of such parts as appear to us to have been defective. All defective parts have to be returned freight prepaid before credit will be issued.

We shall not be liable for transportation charges in connection with the replacement or repair of defective parts.

This warranty does not apply to a Giant-Vac upon which repairs or alterations have been made by others except with our prior written approval.

We shall not be liable for consequential damages or contingent liabilities for the fitness of any Giant-Vac for any particular purpose.

We make no other express, implied or statutory warranty, nor is anyone authorized to make any in our behalf.

---

**GIANT-VAC, INC.  
P.O. BOX 195  
SOUTH WINDHAM, CT. 06266  
PHONE: 860-423-7741 • FAX: 860-423-2654**

---

**PARTS LIST # 5792**

**1103-AL GRASS CATCHER**

REF NO.	PART NO.	DESCRIPTION	QTY
1	27289	Catcher Body	1
2	27292	Front Pivot Pin Bracket	1
3	27293	Rear Pivot Pin Bracket	1
2a-3a*	27294	Pivot Pin Reinforcement Plate	2
2b-3b*	31067	5/16 x 1" bolt, lockwasher & nut	4
4	31689	Dump Cord	1
5	31618	5/16 x 3-1/4" Eye bolt	1
5a*	31027	5/16 flatwasher	2
5b*	31003	5/16 lockwasher	1
5c*	31004	5/16 hex nut	2
6	23214	Catcher Carrying Handle	2
6a*	31027	5/16 flatwasher	8
6b*	31003	5/16 lockwasher	4
6c*	31004	5/16 hex nut	8
7	27290	Catcher Receiving Bracket	1
8	31688	3/8 x 3/4" bolt, lockwasher & flatwasher	4
9	27291	Reinforcement Brace	1
10	31373	3/8 x 1" bolt, flatwasher, lockwasher & nut	2

\* Signifies item not shown

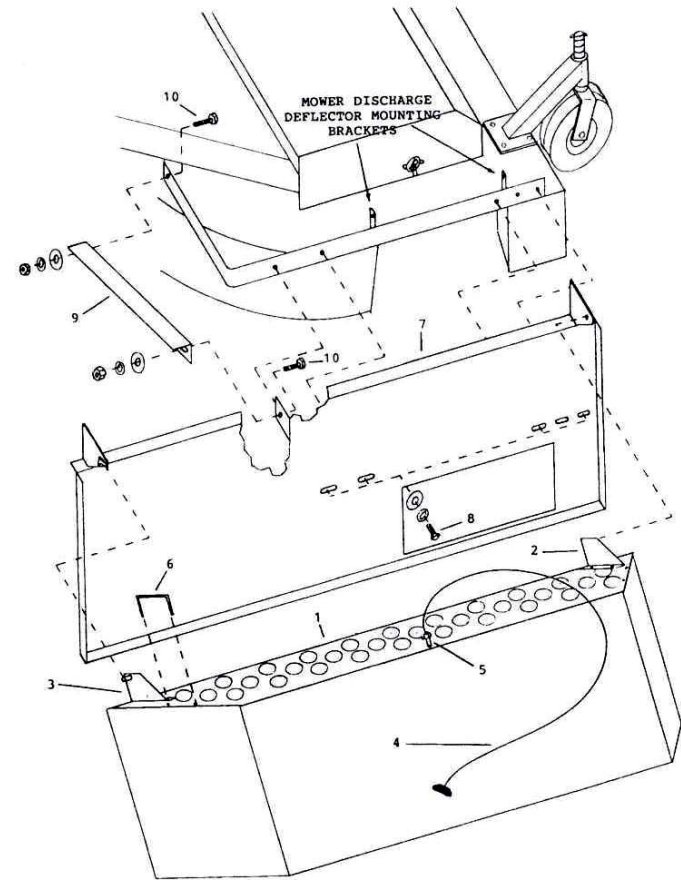

**SPECIFICATIONS SUBJECT TO CHANGE WITHOUT NOTICE**